

POSITRONIC ASIA PTE. LTD. BELIEVES THE DATA ON THE DRAWING TO BE RELIABLE. SINCE THE TECHNICAL INFORMATION IS GIVEN FREE OF CHARGE, THE USER EMPLOYS SUCH INFORMATION AT HIS OWN DISCRETION AND RISK. POSITRONIC ASIA PTE. LTD. ASSUMES NO RESPONSIBILITY FOR RESULTS OBTAINED OR DAMAGES INCURRED FROM USE OF SUCH INFORMATION IN WHOLE OR IN PART.

DATE	REV	REVISION RECORD	DRN	CKD	APP
03 Dec 08	NC	PA ECO 08257	LP	EH	NK
23 Dec 08	A	PA ECO 08282	LP	EH	NK

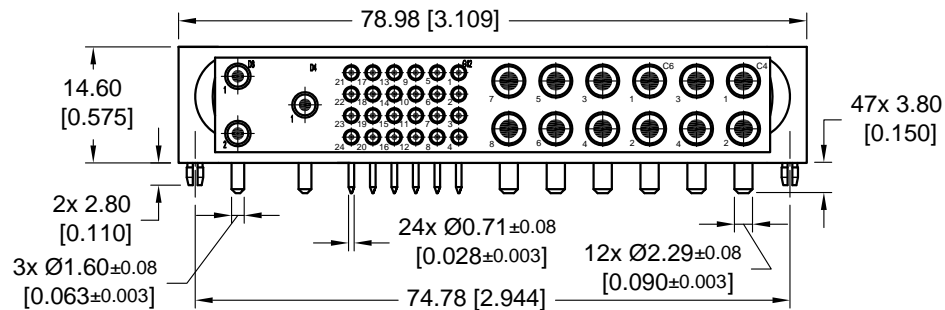

CONTACT HOLES PATTERN

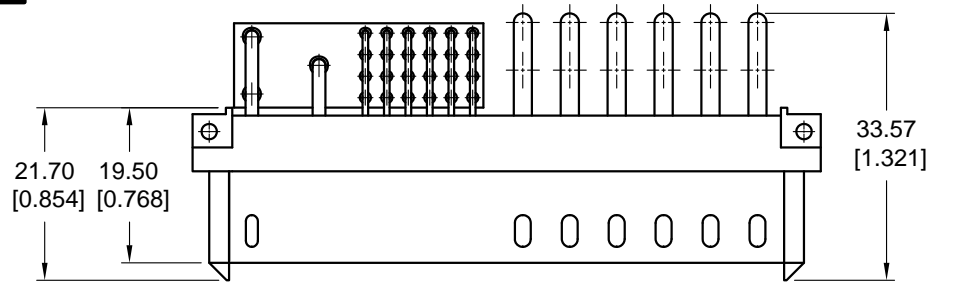
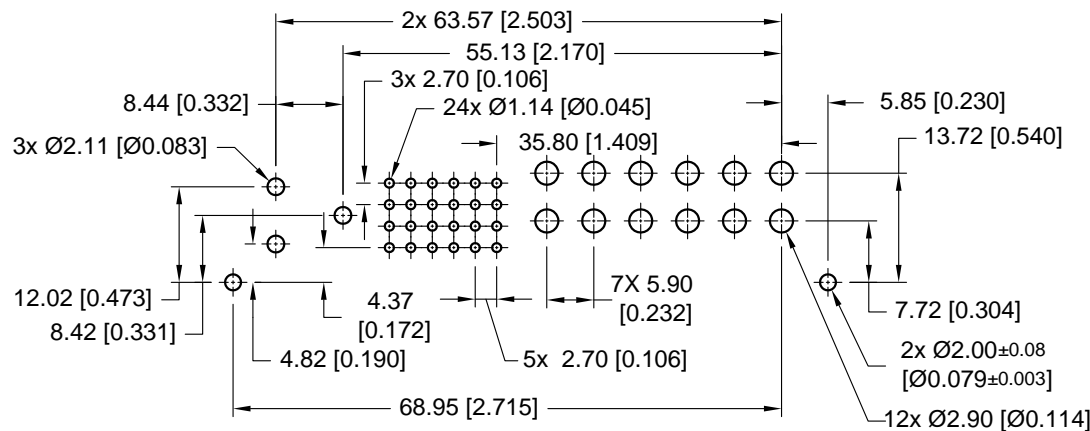

SIZE 16 CONTACTS

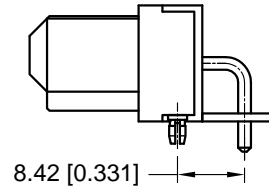

SIZE 16 CONTACTS

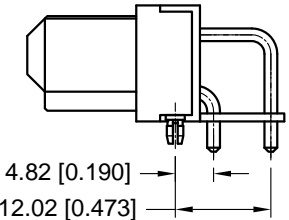

SIZE 12 CONTACTS

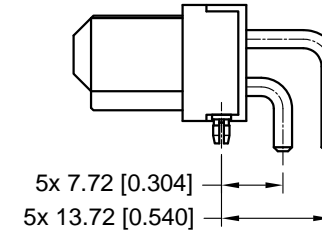

SIZE 22 CONTACTS

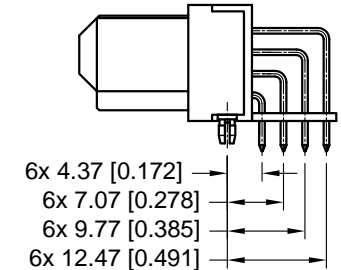

DRAWING NO.	PART NUMBER	REMARKS
ASK21816-1	SP2YGN2TN2AN3B48F0N9	-
ASK21816-2	SP2YGN2TN2AN3B48F0N9/AA	RoHS COMPLIANT PER RoHS DIRECTIVE 2002/95/EC OF 27 JAN 2003

NOTES:

- MATERIALS AND FINISHES
 INSULATOR: GLASS-FILLED POLYESTER, UL 94V-0. COLOR: BLUE.
 POWER CONTACTS: HIGH CONDUCTIVITY COPPER ALLOY WITH GOLD FLASH OVER NICKEL.
 SIGNAL CONTACTS: PRECISION MACHINED COPPER ALLOY WITH GOLD OVER NICKEL PLATE.
 PUSH-ON FASTENERS: BRASS WITH TIN PLATE.



POSITRONIC ASIA PTE. LTD
 3014A UBI ROAD 1, #07-01. SINGAPORE 408703
 Tel: (65) 6842-1419 / Fax: (65) 6842-1421 / Email: singapore@connectpositronic.cc

GENERAL TOL.	SERIES	SCALE	DRAWN	CHECKED	APPROV
	LINEAR : ±0.38 [0.015] ANGULAR : ±5°	SP	NTS	LP	EH
UNLESS OTHERWISE SPECIFIED, ALL DIMENSIONS ARE IN MILLIMETERS [INCHES]	TITLE	DATE	DRAWING NUMBER	REV.	
	SP2YGN2TN2AN3B48F0N9 SP2YGN2TN2AN3B48F0N9/AA	03 Dec 08	ASK21816-*	SHEET 1 OF 1	A